



*moda*

# Be My Neighbor

## Block 5

12" x 18" finished

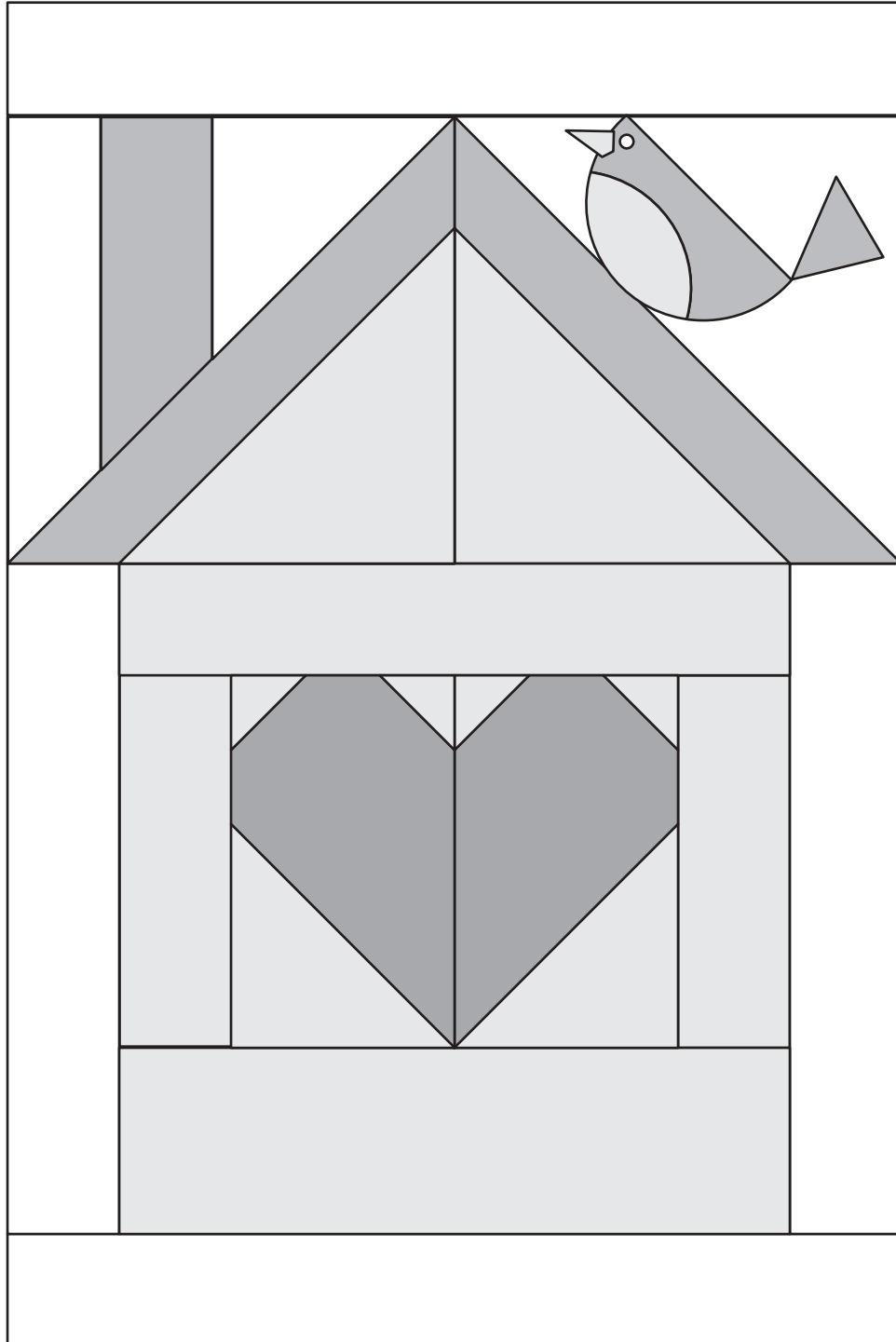

## General Information

- These are very scrappy blocks. Mix your favorite Moda prints to create your colorful neighborhood!
- Share your progress and final quilt at #BeMyNeighbor. We love to see your results!!!

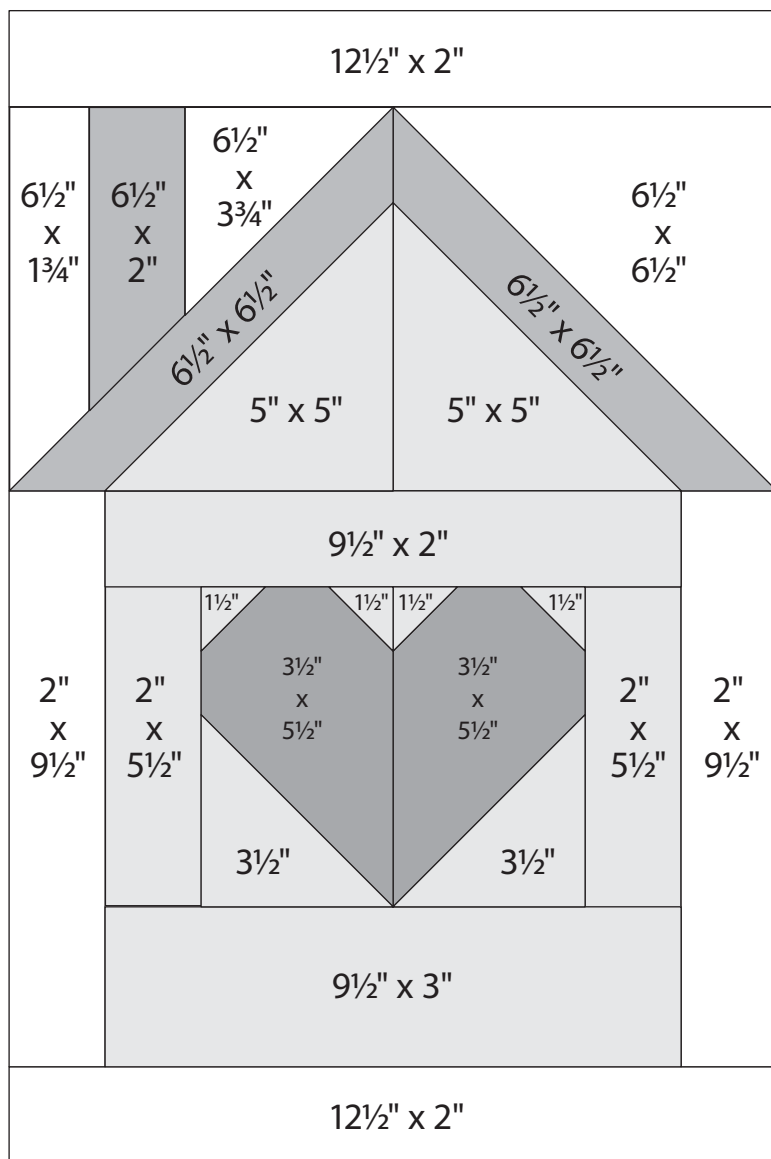

**Block 5**  
12½" x 18½" unfinished

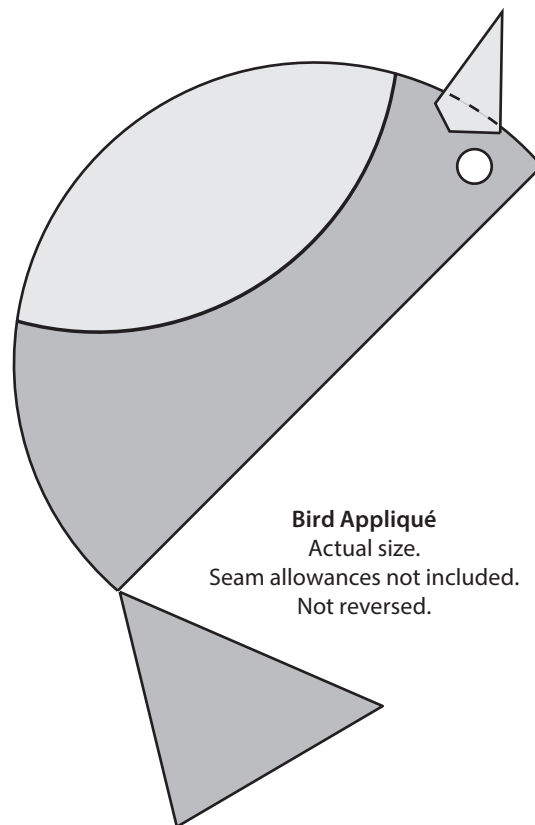

**Bird Appliqué**  
Actual size.  
Seam allowances not included.  
Not reversed.

## Cutting

### House

- 1–9½" x 3" rectangles
- 1–9½" x 2" rectangles
- 2–5½" x 2" rectangles
- 2–5" squares
- 2–3½" squares
- 4–1½" squares

**Roof:** 2–6½" squares

**Chimney:** 1–2" x 6½"

**Heart:** 2–3½" x 5½"

### Background

- 1–6½" square
- 1–6½" x 3¾" rectangle
- 1–6½" x 1¾" rectangle
- 2–2" x 12½" rectangles
- 2–2" x 9½" rectangles

### Bird Appliqué

- 1–beak
- 1–body
- 1–tail
- 1–wing
- 1–eye



# Be My Neighbor

Block 5 is 12" x 18" finished.

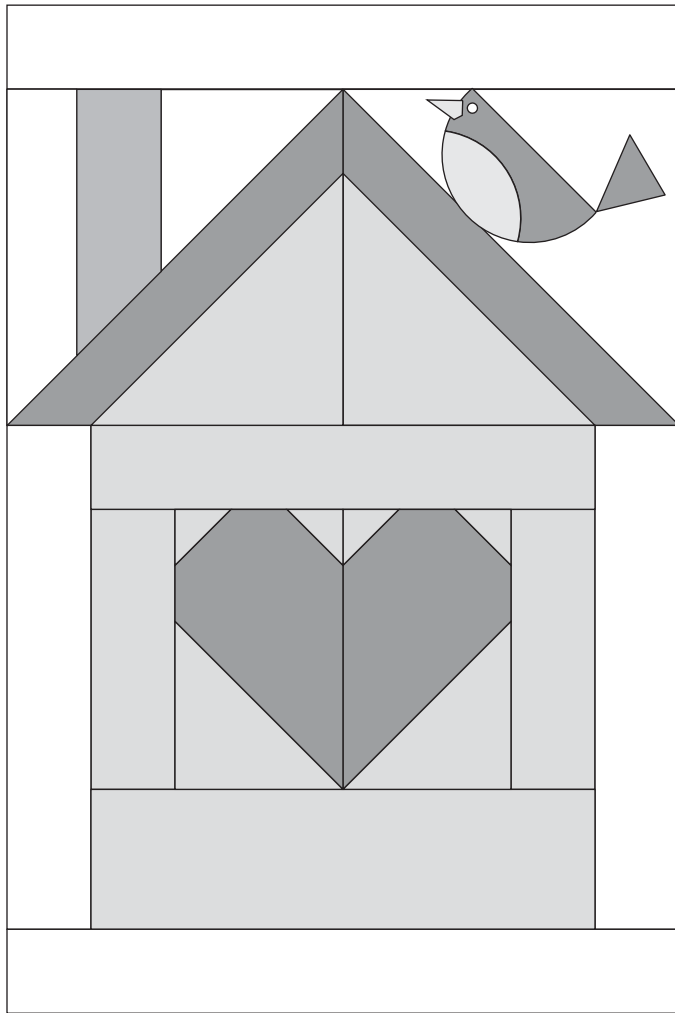

## Construction

Use  $\frac{1}{4}$ " seams. Press in the direction of the arrows in the diagrams.

### 1 Roof

- (A) Join a  $1\frac{3}{4}$ " x  $6\frac{1}{2}$ " background, 2" x  $6\frac{1}{2}$ " chimney, and  $3\frac{3}{4}$ " x  $6\frac{1}{2}$ " background strip as shown.

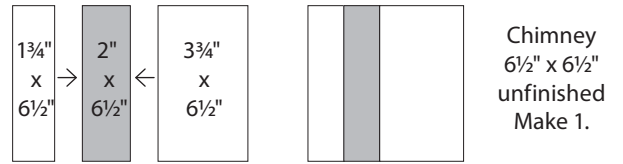

- (B) Draw a diagonal line from corner to corner on the wrong side of 2–5" house squares. Layer a 5" marked house square, right sides together, on 1– $6\frac{1}{2}$ " roof square as shown. Sew on the diagonal line. Trim  $\frac{1}{4}$ " from the sewn line. Press to reveal the triangle. Make 2.

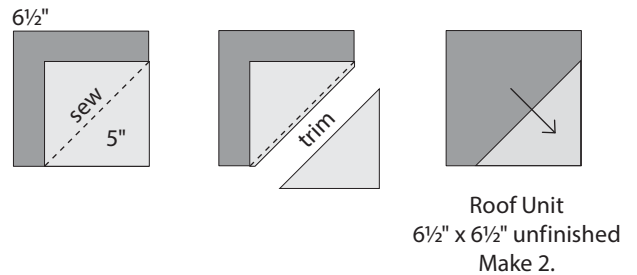

- (C) Draw a diagonal line from corner to corner on the wrong side of the chimney as shown. Layer the marked chimney, right sides together, on a roof unit as shown. Sew, trim, and press. Make 1.

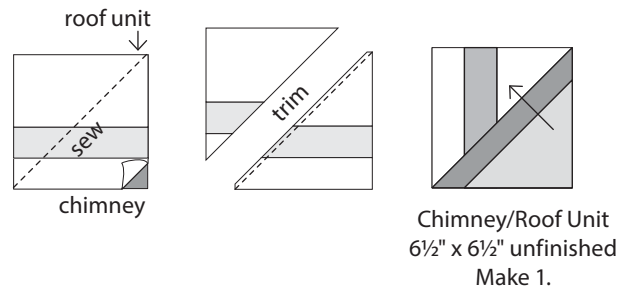

moda

(D) Draw a diagonal line from corner to corner on the wrong side of a 6½" background square. Layer the marked square, right sides together, on a roof unit as shown. Sew, trim, and press to reveal the triangle. Make 1. Join units to make the roof.

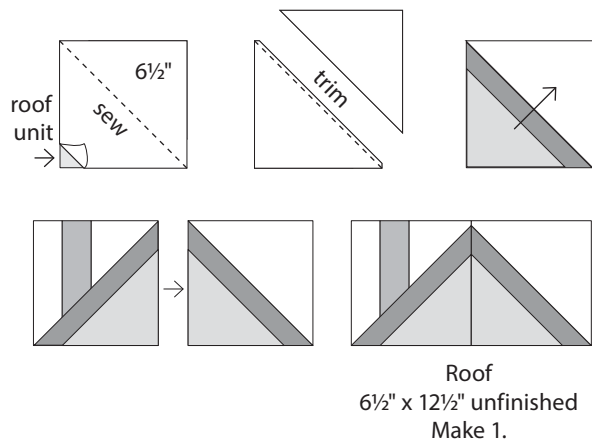

**2 Heart** Draw a diagonal line from corner to corner on the wrong side of 2–3½" house squares, and 4–1½" house squares. Layer, sew, trim, and press as shown on 2–3½" x 5½" hearts. Join the 2 sides to make the heart.

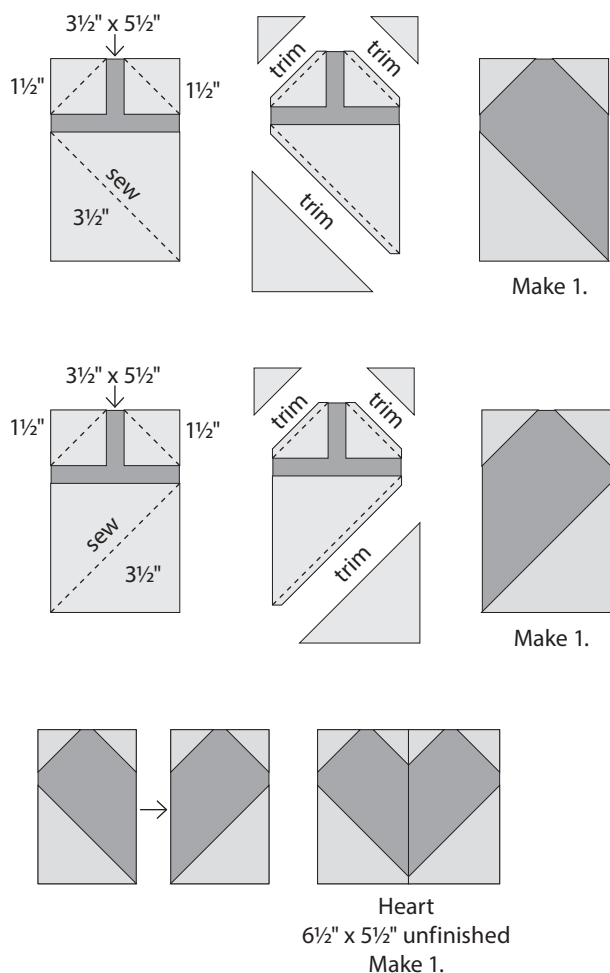

**3 House assembly** Assemble the Heart House as shown. Use fusible web and a zig zag or blanket stitch to add the bird to the completed house block.

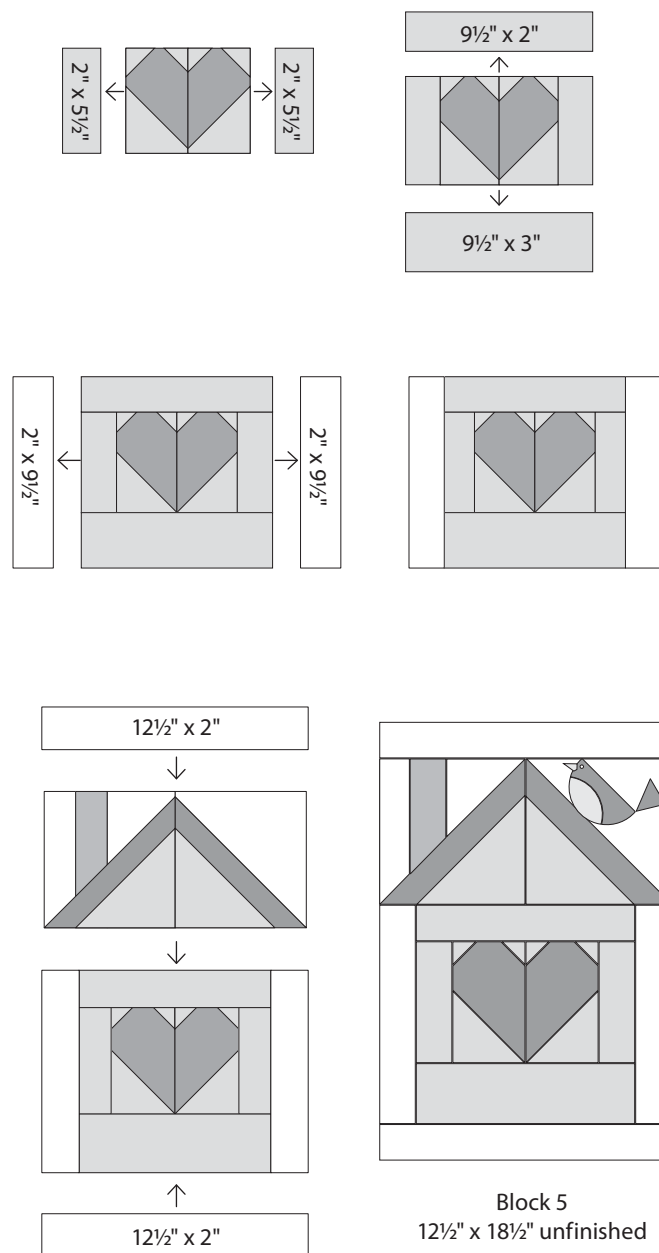

*moda*